



# 33a North End Road



Stromness, KW16 3AG

 2 Bed

 1 Bath

 1 Public

# Region of £95,000



Thinking about selling?

Start with a free market appraisal from Lows. Our experts will guide you through the process, from understanding your home's value to managing marketing and conveyancing seamlessly with our in-house solicitors — all under one roof.



Viewing

For an appointment to view please contact Lows on 01856 873151 or enquiries@lowsorkney.co.uk



All further enquiries should be directed to Lows, to whom all offers should be submitted in writing.

33A North End Road is a 2-bedroom semi-detached dwelling requiring extensive renovation and modernisation.

The accommodation includes a living room/kitchen, bathroom, toilet, 2 bedrooms and storerooms. The property has previously been a shop and may be suitable as office or commercial use subject to the necessary planning consent. Conveniently located close to the swimming pool and schools. Garage and parking space to rear.

Please note that the property is not mortgageable and is being sold as seen.

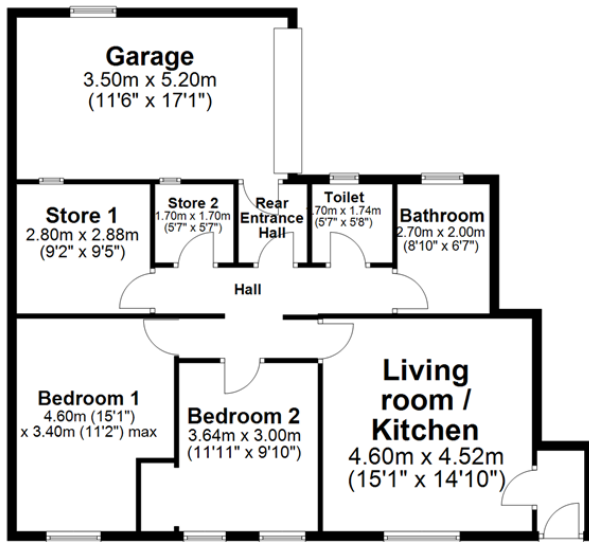

Total area: approx. 101.5 sq. metres (1092.1 sq. feet)

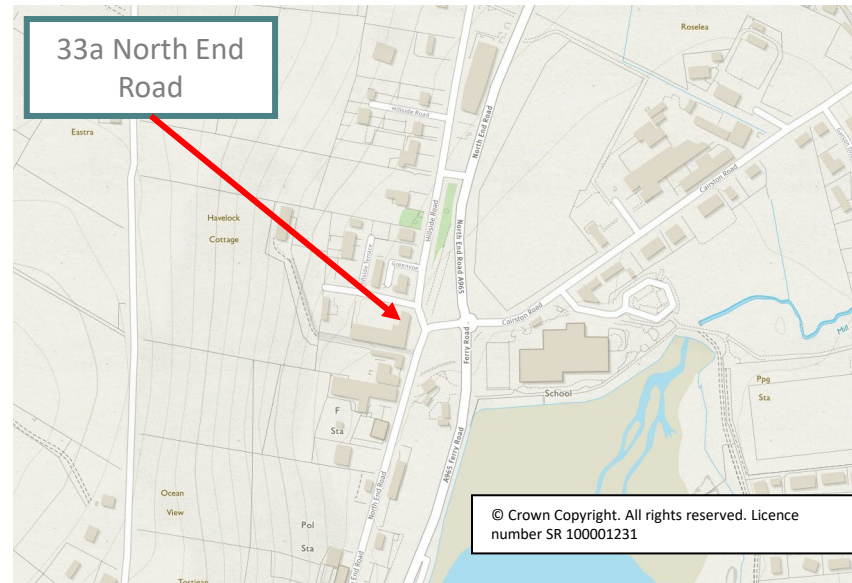

Services: There has previously been mains water and electricity

Entry: By arrangement

[www.lowsorkney.co.uk](http://www.lowsorkney.co.uk)

[Lows Facebook Page](#)

The following notes are of crucial importance to intending viewers and/or purchasers of the property.

1. These particulars do not form part of any offer or contract and all statements and measurements contained herein are believed to be correct but are not guaranteed, and any intending purchaser must satisfy themselves as to their accuracy. Prospective purchasers are advised to have their interest noted through their solicitors as soon as possible in order that they may be informed in the event of an early closing date being set for receipt of offers.
2. No responsibility can be accepted for any expenses incurred by intending purchasers in inspecting properties which have been sold or withdrawn.