



● law ● property ● finance

LOWS

5 Broad Street, Kirkwall,
Orkney, KW15 1DH
Tel. 01856 873151
enquiries@lowsorkney.co.uk

Building Site with Full Planning Permission for a 2 Bedroomed Dwellinghouse at The Knowe, Deerness, extending to $\frac{3}{4}$ acre or thereby

**£30,000 with the completed property
available for £120,000 including the site**



Enjoying views over farmland with the sea in the distance, this building site has full planning consent for a two bedroomed bungalow with the plans showing the exterior wall stone clad to match the neighbouring property.

Site extends to $\frac{3}{4}$ acre including garden and a fenced paddock.

www.lowsorkney.co.uk

Entry: By arrangement

Viewing: Visit the site.

Price: Offers over £30,000

Further enquiries should be directed to Lows Property Shop, with whom all offers should be lodged in writing.

ETCN

The following notes are of crucial importance to intending viewers and/or purchasers of the property:-

1. These particulars do not form part of an offer or contract and all statements and measurements contained herein are believed to be correct but are not guaranteed, and any intending purchaser must satisfy themselves as to their accuracy. Prospective purchasers are advised to have their interest noted through their solicitors as soon as possible in order that they may be informed in the event of an early closing date being set for receipt of offers.
2. No responsibility can be accepted for any expenses incurred by intending purchasers in inspecting properties which have been sold or withdrawn.

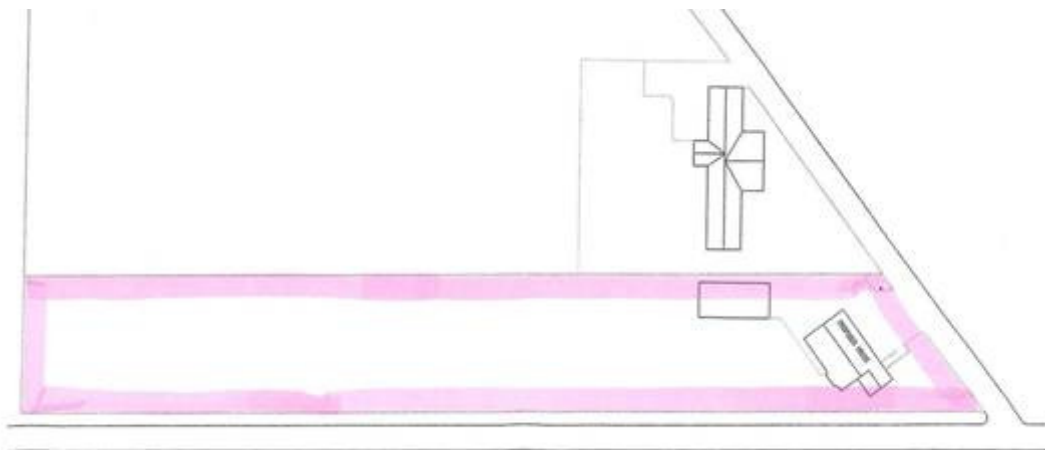



WEST FACE



EAST FACE



GROUND FLOOR PLAN