



## Garage/Workshop, Showroom and Offices, Garrison Road, Hatston, Kirkwall, KW15 1RE

This commercial garage/workshop with showroom and offices is situated on the Hatston Industrial Estate with a forecourt off Garrison Road and the workshops accessed from Scotts Road.

The ground floor extends to 275m<sup>2</sup> or thereby with the offices, on the first floor, a further 50m<sup>2</sup> or thereby.

**OFFERS OVER  
£240,000**

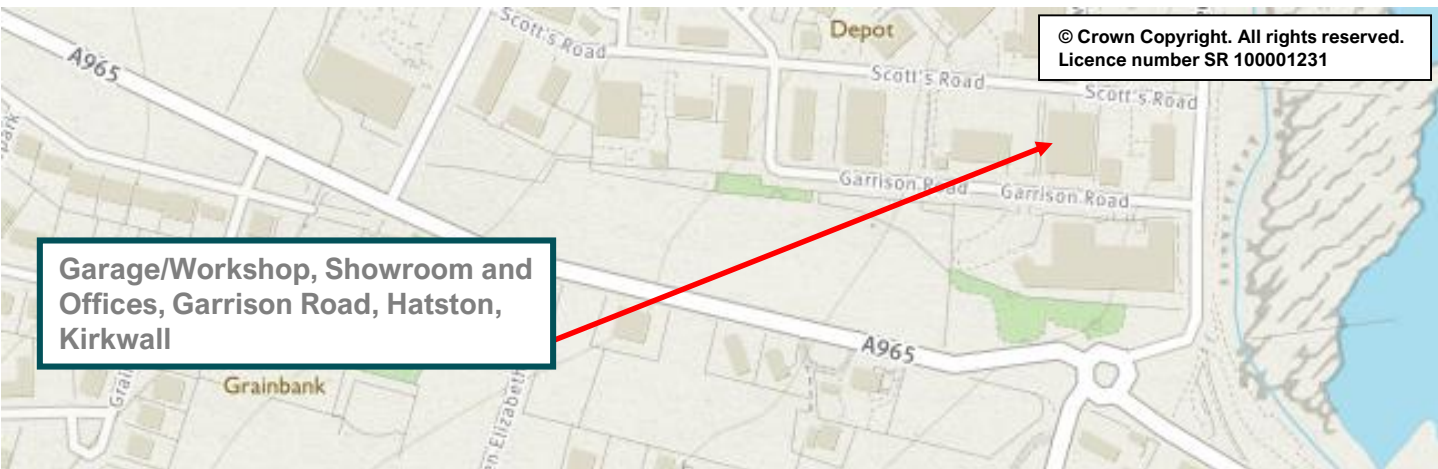
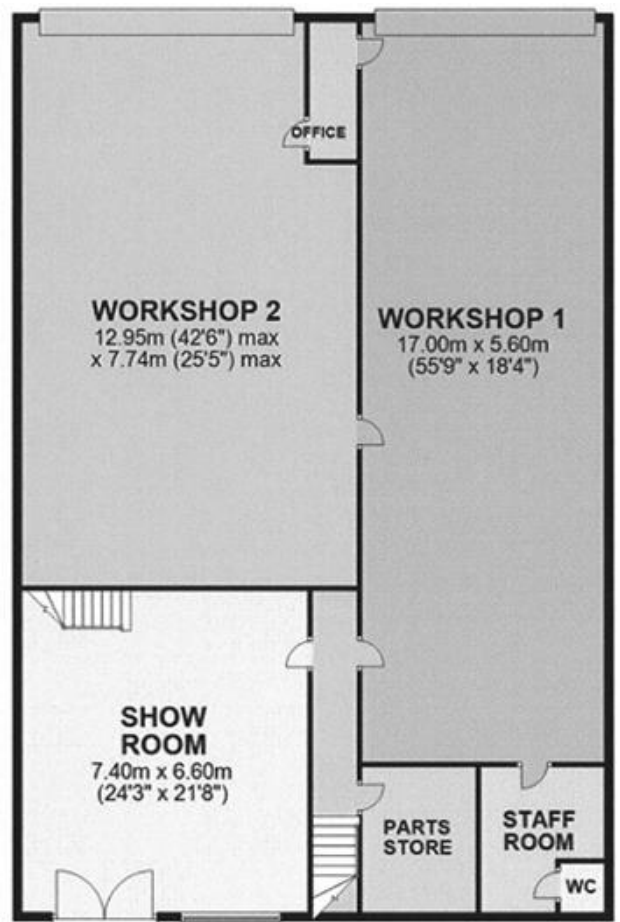

**SERVICES** – Mains services. Telephone.

**RATEABLE VALUE** – £3,800 + £2,900 = £6,700

**ENERGY PERFORMANCE RATING** – T.B.C.

**VIEWING** - For an appointment to view please contact Lows Property Department.

**PRICE** - Offers over £240,000

Further enquiries should be directed to Lows Property Department, with whom all offers should be lodged in writing.

**rightmove**   
find your happy

Lows Solicitors – Estate Agents  
5 Broad Street, Kirkwall, Orkney, KW15 1DH  
T: 01856 873151 F: 01856 875450 W: [www.lowsorkney.co.uk](http://www.lowsorkney.co.uk)

**DMNH**

The following notes are of crucial importance to intending viewers and/or purchasers of the property.

1. These particulars do not form part of any offer or contract and all statements and measurements contained herein are believed to be correct but are not guaranteed, and any intending purchaser must satisfy themselves as to their accuracy. Prospective purchasers are advised to have their interest noted through their solicitors as soon as possible in order that they may be informed in the event of an early closing date being set for receipt of offers.
2. No responsibility can be accepted for any expenses incurred by intending purchasers in inspecting properties which have been sold or withdrawn.